

## Container 1.000 Liter, Typ TCA 11/L

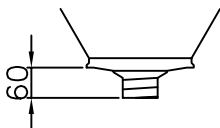
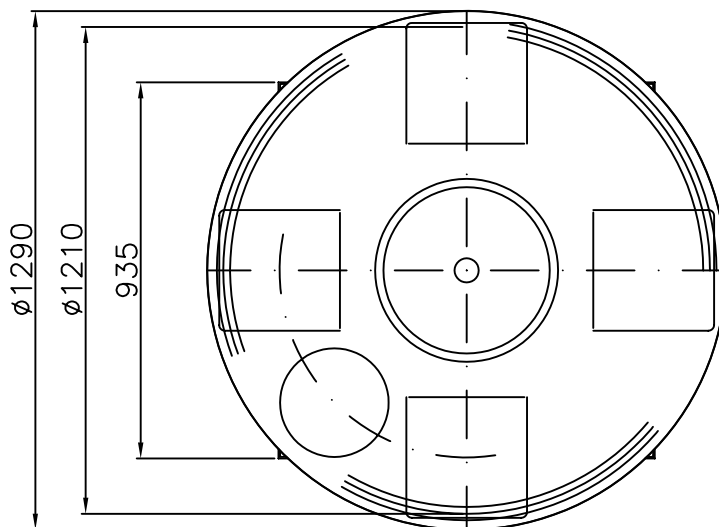
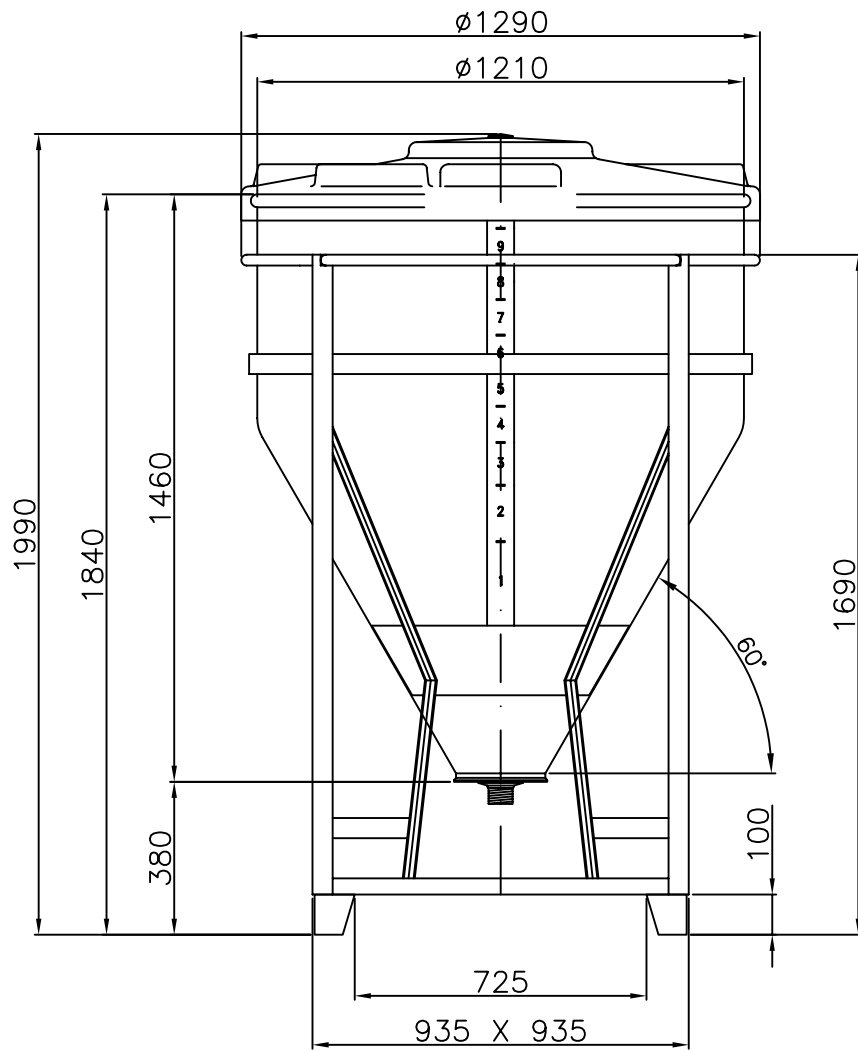

Entleerung:  $\varnothing 1'' - 1\frac{1}{4}'' - 1\frac{1}{2}'' - 2''$  Containerhöhe = 1990 mm  
 Entleerung:  $\varnothing 2\frac{1}{2}'' - 3'' - 4''$  Containerhöhe = 2110 mm