

Container 2.400 Liter, Typ TC 24/L

Löffler

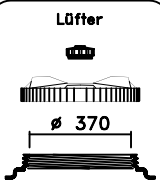

Ø 370
CPF 410

Innenbehälter

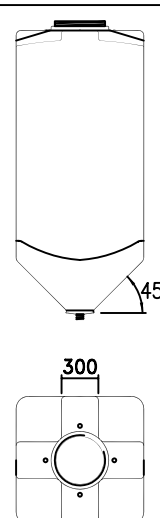

45°
300

Entleerung

Vertikal

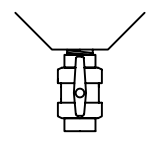

Horizontal

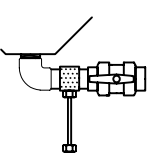

(*)

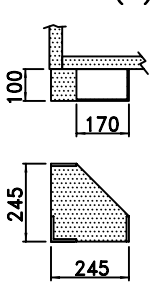

100
170
245
245

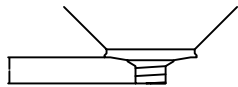
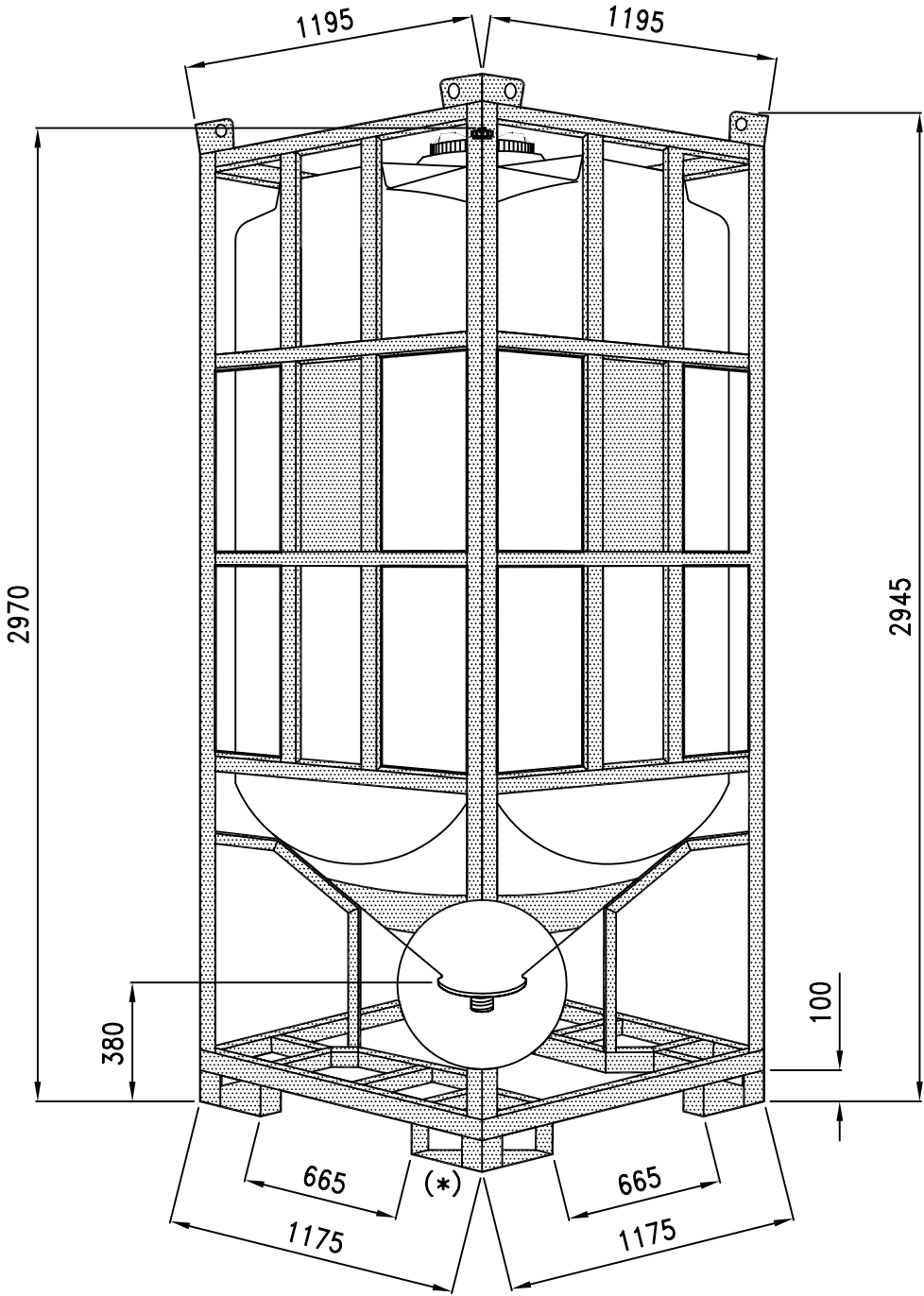

Entleerung : Ø 1" - 1¼" - 1½" - 2" Containerhöhe = 2970 mm
 Entleerung : Ø 2½" - 3" - 4" Containerhöhe = 3090 mm